

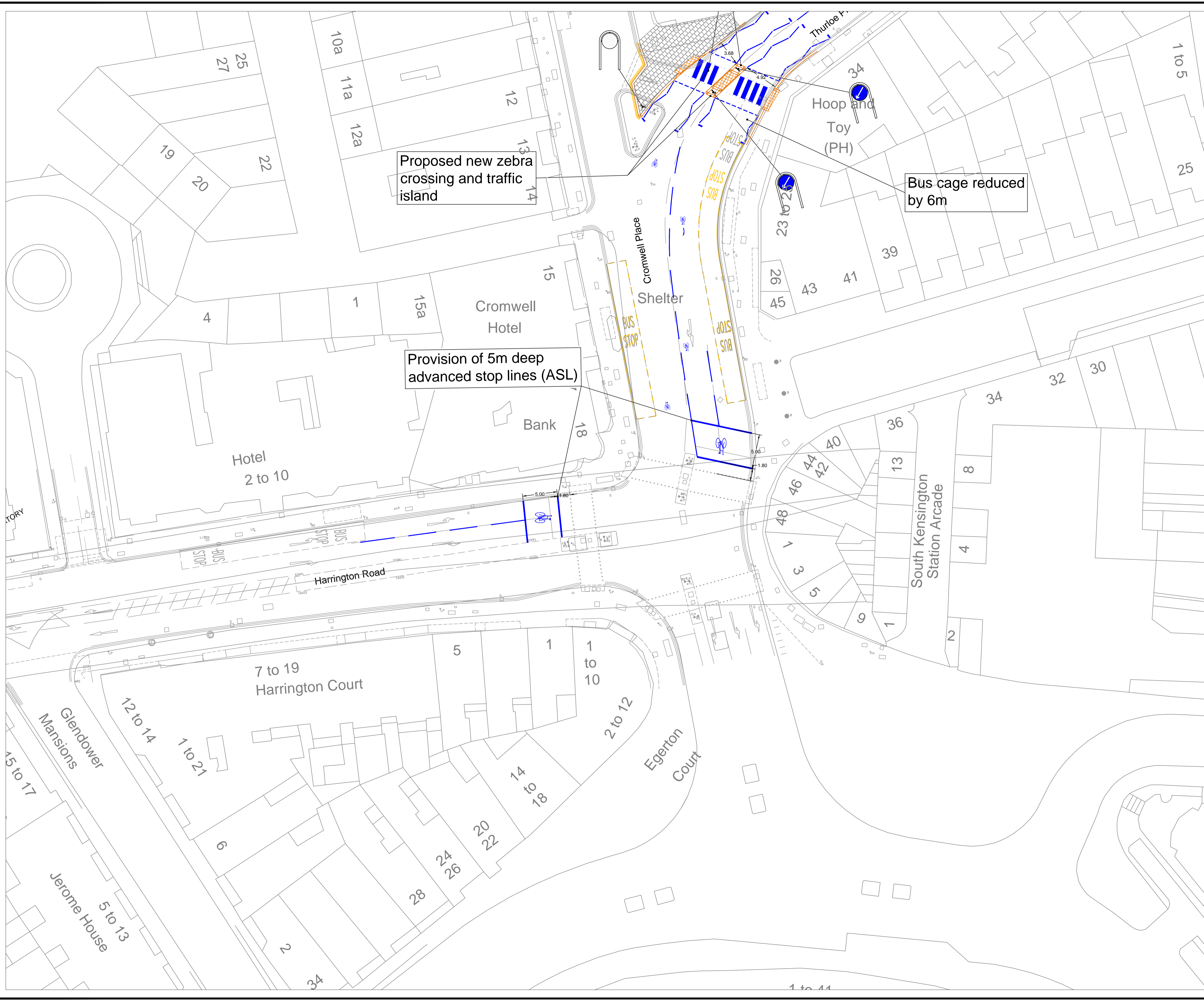

Notes



Rev	Description	By	Date	Chk
1	REMOVAL OF SOUTHBOUND FEEDER LANE AND GAP BETWEEN ASL AND PEDESTRIAN STUDS REDUCED TO 1.8 METRES	SL	06.11.15	

DEPARTMENT OF TRANSPORTATION AND HIGHWAYS
 Traffic & Transportation Policy Service
 The Royal Borough of Kensington and Chelsea
 Town Hall, Hornton Street, London, W8 7NX
 Telephone: (020) 7361 3374
 Fax: (020) 7361 2796

Project				
CENTRAL LONDON CYCLING GRID				
Title				
RBKC QUIETWAY ROUTE PROPOSALS Q49 QUIETWAY (PHASE 2) (CROMWELL PLACE/THURLOE PLACE)				
Scale	Drawn	EE	Checked	A1
1:250	Date	21.09.15	Date	
Drawing Number				Rev
X5015-CYGR-ODES-Q49-012				1

Cad File: 'DRAWINGS'...