

# **Air Quality and Climate Change Action Plan 2016–2021**

## **Actions Completed 2016-2018** January 2019



THE ROYAL BOROUGH OF  
KENSINGTON  
AND CHELSEA

# Overview

This report lists all the actions completed since the Air Quality and Climate Change Action (AQCCAP) 2016-2021 was published in 2016 up to 2018. It outlines the progress achieved against the target/measure agreed and described the initiatives undertaken by the Council to deliver and completed this action. Some of the actions are ongoing and are included in the updated Air Quality and Climate Change Action Plan Version 2 as new actions.

The Action numbers given in the first column of the list of actions below should be read in conjunction with the original AQCCAP available here: [www.rbkc.gov.uk/AQCCAP](http://www.rbkc.gov.uk/AQCCAP).

## Action Plan – Completed Actions 2016-2018

### Keys to reading the Action Plan

**Key 1** below categorises the actions listed in the following plan by type. In the live version, the reader will be able to create bespoke lists of actions based on these types.

Key 1: Action type											
Directly Improve Health	<b>H</b>	Change Behaviour	<b>B</b>	Directly Reduce Air Pollution	<b>P</b>	Directly Reduce CO <sub>2</sub>	<b>C</b>	Increase Resilience	<b>R</b>	Lead by Example	<b>L</b>

**Key 2:** A '+' sign illustrates that the action has an impact, either direct or indirect, on reducing emissions of NO<sub>2</sub>, PM or CO<sub>2</sub>. In the example below, the action has an impact on all three types of emission.

Action	NO <sub>2</sub>	PM	CO <sub>2</sub>
Encourage cycling as a non-polluting mode of transport and combat obesity	+	+	+

**Key 3** provides a definition of the abbreviations used in the 'Body responsible' field in the action list. They are all functions within the Council.

Key 3: Body responsible			
CC	Climate Change	PH	Public Health
CpS	Corporate Services	PL	Parks and Leisure
Ec	Ecology	PI	Planning
EcD	Economic Development	Tr	Transportation
Ed	Education	Hou	Housing
EH	Environmental Health	W	Waste and Street Enforcement
Hi	Highways	WA	Waste Action
HS	Health and Safety Team in Environmental Health	RBEP	Royal Borough Environment Projects

## PUBLIC HEALTH

- 7.6% of all deaths in the Royal Borough are attributed to particulate air pollution.
- NO<sub>2</sub> leads to respiratory disease, increased symptoms, A&E visits and hospital admissions.
- The odds of dying from cardiovascular or respiratory causes increase by over 10% for every 1°C rise in temperature.



N <sup>o</sup>	Action type	Action	Description	Body responsible	Target/measure	Deadline	Closing comments / progress
1	H B	<b>Support vulnerable patients discharged from hospital with heart and lung conditions</b>	Provide air quality advice and home modifications for discharged hospital patients, particularly the most vulnerable (i.e. children/elderly) with heart and lung diseases.	EH/PH	Joint project implemented	Mar-16	Project with Global Action Plan completed. Under the new Bi-Borough restructure a Public Health Business Partners model has been launched. One of these PHBP will partner with the NHS to deliver Public Health's joint collaborative priorities which include Air Quality so further work with vulnerable patients is anticipated through this mechanism.
5	H B	<b>Produce policy guidance on the use of e-cigarettes in the workplace</b>	Develop policy guidance for commercial premises on the use of e-cigarettes in the workplace to improve indoor air quality.	PH/HS	Policy guidance produced	Dec-16	(No local pollution benefit)  PHE guidance published in July 2016. Review of e-cigarette policy undertaken by PH in 2017 with a view to informing workplace and Council vaping policies. Not yet developed into policy guidance for commercial premises. Due to rapidly evolving body of evidence all policies relating to vaping are reviewed regularly.  Constantly review and update according to the emerging evidence base.

N <sup>o</sup>	Action type	Action	Description	Body responsible	Target/measure	Deadline	Closing comments / progress
7	H B	<b>Encourage cycling as a non-polluting mode of transport and to combat obesity</b>	Promote cycling through GPs and GP Navigator, Health Trainer and Cycle Coordinator schemes to improve heart/respiratory health, combat obesity and promote non-polluting transport modes.	EH/PH	Promotion targeting vulnerable residents part of normal business	Dec-16	As part the GoGolborne obesity pilot, a Pedal and Stride Campaign has been launched focusing in promoting active travel in partnership with the Sustainable Travel Team. This mini-campaign is providing an extra push on all of the Sustainable Travel team's services in Golborne. Activities include: <ol style="list-style-type: none"> <li>1. working with all organisations to develop a travel plan,</li> <li>2. running training for Walking Leaders,</li> <li>3. worked with schools to put on special activities for 'Walk to School Week',</li> <li>4. provide grants to local organisations to deliver walking and cycling projects e.g. secure bike sheds, bikes for disabled children,</li> <li>5. developed walking maps of the local area, and</li> <li>6. commissioned Living Streets to undertake a street audit and then working with local residents to implement recommendations and make the area more walkable.</li> </ol>
8	H B	<b>Support financial saving schemes that aid residents living in fuel poverty</b>	Support the delivery of the Big Energy Switch 2015, a collective energy switching scheme to help residents negotiate tariffs on gas and electricity to aid those living in fuel poverty in line with the Healthier Homes scheme.	EH/CC	100 residents subscribing	Mar-16	The borough has been involved with the Big London Energy Switch for a number of auctions and will continue to promote tariff switching as a way of cutting bills and reducing fuel poverty. This is promoted through our website and press releases. The borough also undertakes a number of different measures to ensure that those residents who do not have access to online switching can still receive assistance. Healthier Homes attends a number of events throughout the year including the annual Health Fair, Community Champions and Carer's events. Healthier Homes will visit individuals in their homes to assist with switching and tariff advice.

N <sup>o</sup>	Action type	Action	Description	Body responsible	Target/measure	Deadline	Closing comments / progress
							<p>Healthier Homes also supports and promotes the Winter Fuel Fund administered by the Kensington &amp; Chelsea Foundation. This collects donated winter fuel payments and additional charitable donations and distributes them to older residents who have received very high fuel bills.</p> <p>We have also funded a post based in our local Citizens Advice to provide specific advice and specialist support for fuel debt and this includes switching and tariff advice and the promotion of the warm homes discount.</p> <p>Healthier Homes also promotes the Warm Homes Discount through leaflets and during events and visits.</p> <p>Healthier Homes undertakes home visits and will assist residents on an individual basis to identify the best tariffs for their circumstances and help them to switch. When we are able to work with the Green Doctors they will also undertake switching and tariff advice during their home visits.</p>

## BUILDINGS AND NEW DEVELOPMENTS

- **NO<sub>2</sub> emission contribution: 8% from construction; 27% from gas boilers**
- **PM10 emission contribution: 10% from non-road mobile machinery (NRMM); 6% from gas boilers**
- **CO<sub>2</sub> contribution: 60% from commercial buildings; 29% from residents' homes**

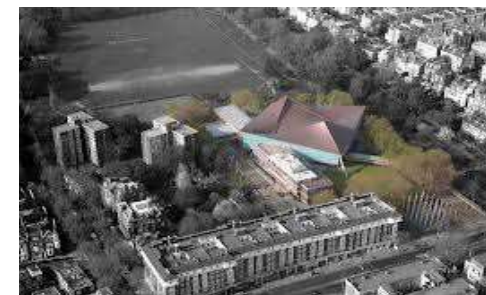

No	Action type	Action	Description	Body responsible	Target/measure	Deadline	Closing comments / progress
10	HBPC	<b>Support vulnerable residents to reduce energy consumption and bills</b>	Support residents by providing energy efficiency advice and by installing small and low-cost energy efficiency measures to combat climate change. Reduce their energy bills and carbon footprint through the Healthy Homes project and through home energy visits by trained green experts.	CC/Hou	Number of home energy visits	Winter 16/17	<p>The Healthier Homes project is a local referral based project run by the council in partnership with the third sector aimed at reducing fuel poverty amongst local residents.</p> <p>The project helps residents through a mixture of measures. Advice and information is provided through the website, leaflets and posters. We also provide bespoke and open training sessions for council, health and third sector groups to help them identify and make appropriate referrals.</p> <p>Healthier Homes visit residents in their properties to assess the most appropriate course of action, this may be through advice and small measures, or grants or enforcement. Where Healthier Homes cannot help directly it makes referrals on to other more appropriate organisations.</p> <p>These include local third sector organisations, other council departments and the Green Doctors for energy efficiency and in particular the installation of small measures notably draught proofing.</p>

No	Action type	Action	Description	Body responsible	Target/measure	Deadline	Closing comments / progress
							<p>In the financial year 2017-2018 the project received 87 referrals and made over 60 home visits. 19 referrals for heating installations, repairs or servicing were made. A further 4 referrals were made for other grant aided works.</p> <p><b>Free home energy visits – Green Doctors</b>                      The free Green Doctors home energy scheme is an ongoing project delivered by Groundwork London to support RBKC residents vulnerable to cold homes and / or whose health and wellbeing is compromised by poor housing conditions and inefficient homes.</p> <p>Between 16/18 more than 500 home energy visits were delivered for RBKC residents, vulnerable to the effects of living in cold housing, identified as being elderly, on benefits and/or disadvantaged. Low energy efficiency measures (such as draught proofing, energy efficient light bulbs, radiator panels, TV power downs, shower heads etc.) were installed and winter warm packs were provided. RBKC has also been part of the WARMTH programme, coordinated by Groundwork and funded by the British Gas Home Energy Fund (11 London boroughs involved).</p> <p>In 2018, the Council has secured external funding from the Warm Homes Fund to deliver a similar fuel poverty (home energy programme) project – Homes4Health for the next three years. More than 600 vulnerable residents will benefit from the fuel poverty programme.                      The Council’s Homes4Health programme provides free home energy support and visits to residents to</p>



No	Action type	Action	Description	Body responsible	Target/measure	Deadline	Closing comments / progress
							help them keep warm, make their home energy efficient, save money on their energy bills and improve their health.
12	P C L	<b>Improve the energy efficiency of the six main Council buildings</b>	Deliver energy efficiency projects in six of the Council's main facilities (Town Hall, Chelsea Old Town Hall, Pembroke Road, Carlyle building, Violet Melchett and Pembroke Road car park).	CpS	Reductions of 974 tonnes of CO <sub>2</sub> and 721.5kg of NO <sub>2</sub>	Mar-17	<p>There have been 619 tons of CO2 savings from the energy delivered up to April 2018.</p> <p>Further 50 tons of CO2 related projects have been identified for 2018/2019 (pending approval).</p>
13	P C L	<b>Improve the use of space in Council buildings to increase occupancy and reduce overall energy demand</b>	Improve the use of Council buildings, making them more sustainable, flexible and cost- and space-efficient, so that the remaining sites are more energy- efficient. This includes the closure of unsuitable and energy-inefficient Council sites (e.g. Pembroke Road).	CpS	Reductions of 845 tonnes of CO <sub>2</sub> and 626kg of NO <sub>2</sub>	Mar-17	<p>The Grenfell tragedy has had a significant impact on the Councils plans to rationalise its operational footprint and reduce energy consumption.</p> <p>2 new operational buildings have had to be acquired to provide essential Grenfell Recovery related services and a significant influx of new staff at KTH will also provide for an increase in energy usage.</p> <p>Similarly, Council Offices at 37 Pembroke Road are no longer planned for redevelopment and will now be refurbished so that they may continue to provide council office accommodation. Canalside House relocation is now no longer taking place and there is also a commitment to accommodate c150 former Tenant Management Organisation staff in the Councils operational estate by 2020.</p>

No	Action type	Action	Description	Body responsible	Target/measure	Deadline	Closing comments / progress
14	P C L	<b>New Marlborough Primary school to be performing at a high standard of energy efficiency</b>	Reduce energy consumption in the redeveloped Marlborough school complex.	CpS/Ed	X tonnes CO <sub>2</sub> reduction (tbc). Achieve BREEAM 'Very Good' standard, which includes effective energy reduction measures	Dec-17	School was constructed with a BREEAM 'Very Good' rating. The climate change team is part of the project team ensuring sustainability and energy efficiency is considered at all stages of the project. The school was completed in August 2017, and is now in use.
15	P C L	<b>Continue to insulate the heating systems in schools</b>	Deliver and support flange and valve insulation projects to a large number of schools.	Ed/CC	Reductions of 75 tonnes of CO <sub>2</sub> and 55.6kg of NO <sub>2</sub>	Mar-17	<p>This is an ongoing initiative.</p> <p>Since 2014, 21 RBKC schools (out of the 36 schools included in the carbon scope/portfolio) benefited from boiler insulation work (flange and valve) improvement projects. These works are expected to save around 111.18 tonnes of CO<sub>2</sub> per year.</p> <p>The following schools were identified in 2017 /18 as potential sites for doing plant room insulation (insulating the boiler pipes): St Joseph's RC Primary School, St Mary Abbots CE Primary School, St Barnabas &amp; St Phillips CE Primary School, Fox Primary School and Barlby Primary School. However, out of these schools only two schools were found lacking F&amp;V insulations such as: St Joseph's Catholic Primary School and St Mary Abbots CE Primary School. These projects will be schedule for completion. The F&amp;V works can reduce the amount of heat being wasted through exposed flanges, valves and pipework.</p>

No	Action type	Action	Description	Body responsible	Target/measure	Deadline	Closing comments / progress
16	P C L	<b>Make sure that boilers in schools are set up and controlled to better adapt heating to each school's needs</b>	Deliver heating health check projects to a large number of schools.	Ed/CC	Reductions of 185 tonnes of CO <sub>2</sub> and 137kg of NO <sub>2</sub>	Mar-17	<p>This is an ongoing project/initiative in schools.</p> <p>One school (Avondale School) have had heating controls work done in 2017 as a result/ recommendation of the heating health checks.</p> <p>The heating health check project delivered at Avondale School is expected to reduce approximately 1.94 tonnes of CO<sub>2</sub> annually.</p>
17	C L	<b>Continue to install energy-efficient LED lighting in schools</b>	Deliver lighting projects within selected schools to increase the use of LEDs and energy-saving fittings.	Ed/CC	Reductions of 40 tonnes of CO <sub>2</sub> and 29.6kg of NO <sub>2</sub>	Mar-17	<p>This is an ongoing initiative.</p> <p>The LEDs project is an ongoing initiative delivered by the Climate Change Team in partnership with RBKC schools.</p> <p>In 2018, a Schools Energy Programme working group was set up by the Corporate Property colleagues and also includes representatives from the Climate Change Team and Children Services. An energy efficient work programme is currently being drafted.</p> <p>During 2017/18, the Council installed LED lighting systems in four RBKC schools. This work is estimated to save 30.07 tonnes of CO<sub>2</sub> per year.</p> <ul style="list-style-type: none"> <li>• Oratory RC Primary School: This work is estimated to save 2.7 tonnes of CO<sub>2</sub> per year.</li> <li>• St Barnabas &amp; St Phillips School: This work is estimated to save 11.26 tonnes of CO<sub>2</sub> per year.</li> <li>• St Mary Abbots Primary School: This work is estimated to save 4.16 tonnes of CO<sub>2</sub> per year.</li> </ul>

No	Action type	Action	Description	Body responsible	Target/measure	Deadline	Closing comments / progress
							<ul style="list-style-type: none"> <li>St Francis of Assisi Catholic Primary School: This work is estimated to save 11.95 tonnes of CO<sub>2</sub> per year.</li> </ul> <p>Since 2014, the Council installed LEDs into 13 RBKC schools. These projects are estimated to bring a total reduction of 138.15 tonnes of CO<sub>2</sub> per year.</p> <p>The Council will continue to work with the schools in the Borough and will assist other schools to convert to LEDs.</p>
18	CL	Introduce more energy-efficient street lighting	Introduce more efficient lighting technology for street lighting.	Hi	Reductions of 129 tonnes of CO <sub>2</sub> and 95.6kg of NO <sub>2</sub>	Mar-17	<p>Difference between 2016/17 to 2017/18 the reduction was 814 Tonnes CO<sub>2</sub> Emission Factor 0.38146.</p> <p>Nitrogen Dioxide reduction is estimated at 598.5 tonnes.</p>
19	HBPCRL	Produce an energy strategy for council housing	Complete the council housing energy strategy to guarantee energy efficiency and more resilient buildings in the Council's housing stock and reduce fuel poverty.	Hou	Strategy agreed and published	Mar-16	A new stock condition survey has been commissioned and will report in 2018/2019 leading to a review of the energy strategy.
23	PCL	Complete energy efficiency refurbishment for the Council's housing estates	Incorporate energy efficiency into the planned refurbishment work programme of the Council's housing estates.	Hou	X energy efficiency measures implemented (tbc)		<p>Two Green doctor events held in 2016/17.</p> <p>Due to other priorities in services and a change to the management structure, no action has been taken or reported this year.</p>

No	Action type	Action	Description	Body responsible	Target/measure	Deadline	Closing comments / progress
24	B P C	<b>Raise awareness on air quality and climate change issues amongst council tenants</b>	Raise awareness of air quality and climate change issues, by advising council tenants on efficient use of heating systems using specific guidelines.	Hou	Number of campaigns undertaken accompanied by advice	Dec-17	Due to other priorities in services and a change to the management structure, no action has been taken or reported this year.
26	C R	<b>Implement the forthcoming legislation related to CO<sub>2</sub> emissions for new developments and major refurbishments</b>	Support implementation of the government's Housing Standards Review with regard to energy standards through emerging alterations to the London Plan, revisions to the Local Plan, determination of planning applications and through building regulations.	PI	Approach agreed and implemented	Dec-16	As per 2016. The Local Plan Partial Review (LPPR) is currently at examination with hearings held in February and March 2018. Once the Inspector's report is received (expected in summer 2018), the Council will be in a position to adopt this policy.
31	B L	<b>Publish online real-time information about the energy used and generated by the Council's main buildings</b>	Publish online real-time information on CO <sub>2</sub> emissions from the Council's main buildings, as well as energy generated by the Council's solar panels.	CC	CO <sub>2</sub> emissions published	Ongoing	<p>The Council was displaying its live energy consumption data online via the Carbon Culture platform. Ongoing problems with getting live energy data feeding into the platform and using the interactive platform features were identified in 2017. Two meetings took place in summer 2017 to address these issues, however Carbon Culture was not able to accommodate and solve the issues for the Council to successfully display and use the data.</p> <p>The Council is currently investigating alternatives ways to display its live energy consumption and carbon emissions on the RBKC website. New platform and/or innovative solutions are explored.</p>

## TRANSPORT: CYCLING, CAR AND GOODS VEHICLE USAGE

- NO<sub>2</sub> emission contribution: 49% from road transport
- PM10 emission contribution: 75% from road transport
- CO<sub>2</sub> contribution: 11% from road transport



No	Action type	Action	Description	Body responsible	Target/measure	Deadline	Closing comments / progress
32	HPCL	<b>Continue to reduce the Council's vehicle emissions</b>	Start with a review of the engine types of all Council vehicles to find opportunities to procure the cleanest Council fleet.	CC	46% CO <sub>2</sub> reduction versus 2007/08	Mar-17	<p>The Council approved and publish in September 2018 its <a href="#">Green Fleet Strategy and Action Plan</a> (2018-2022) with the aim to reduce carbon emissions and pollution and improve the health and wellbeing of staff by encouraging active travel.</p> <p>The Strategy introduces a Green Fleet Procurement process which requires to procure ultra-low and low emission vehicles (electric or hybrid) and a travel hierarchy which has cycling and walking at the core. As part of the delivery and implementation, more than 20 charging points at different Council offices will be installed in 2019 and 2020.</p> <p>In 2017 the Energy Saving Trust conducted a review of the vehicles used by the Council (65 leased vehicles), including its Grey Fleet (vehicles privately owned or leased by employees but used for business travel).</p> <p>The review analysed the Council's fleet in terms of energy consumption, emissions and cost. The review also included recommendations on how the</p>

No	Action type	Action	Description	Body responsible	Target/measure	Deadline	Closing comments / progress
							<p>Council can adopt a green and low pollution fleet strategy and procure a zero tailpipe emission fleet. The Green Fleet Strategy was developed using the data and results of the survey.</p> <p>Eco-driving training for the Council's and contractors' drivers have been organised. The training sessions took place in February and March 2018 with the aim to encourage and educate Council and contractor staff in eco/efficiency driving best practice (fuel efficient driving and smart driving training).</p> <p>48 eco-driving training sessions were delivered for Council and contractor's staff that are using conventional petrol/ diesel cars.</p> <p>22 eco-driving training sessions were delivered for Council and contractor's staff that are using electric vehicles. 8 more eco-driving training sessions were delivered for staff using conventional petrol &amp; diesel cars.</p>
33	P L	<b>Continue to reduce emissions from our contractor's waste collection and street cleaning vehicles</b>	Work with our waste contractor to reduce emissions from its fleet.	CC/W	35% CO2 reduction versus 2007/08	Mar-17	<p>All new waste fleet vehicles have Euro 6 engines (no retrofitting of old vehicles will take place). This doesn't impact CO2 but has significant lower NOx and PM10 emissions.</p> <p>In 2017/18, Suez (the waste contractor) have reduced their CO2 emissions by 33.3% or 429 tonnes of CO2 since 2007/08 (baseline year).</p> <p>The emissions from this area are related to fuel consumption within their fleet and it accounts for</p>

No	Action type	Action	Description	Body responsible	Target/measure	Deadline	Closing comments / progress
							<p>5.75% of the Council's total emissions.</p> <p>Suez (Council contractor) are aiming to make collection routes more efficient where possible. For example, the garden waste service collections have been reduced from three days a week collection to one day per week from April 2017. Other options to make collections routes more efficient are currently being investigated by Suez.</p> <p>A site visit to Dennis Eagle (suppliers of the Refuse Collection Vehicles) took place to discuss their new electric vehicles and to arrange a pilot when the vehicles come into production in 2019. Suez are interested in exploring bio-fuel and electric vehicle options once the technology is reliable.</p>
34	HBPC	<b>Maintain an up-to-date Council Travel Plan</b>	Undertake staff survey and site audits, and revise the travel plan.	Tr	An updated Travel Plan	Apr-16	<p>Staff survey undertaken in Autumn 2016, next survey due September 2018.</p> <p>39 new cycle parking spaces and a repair stand and tyre pump provided at Pembroke Road offices in 2017, improvements made to cycle parking and shower areas at Kensington Town Hall.</p>
37	HBPC	<b>Encourage residents to choose low-emission vehicles by raising diesel surcharge</b>	Increase the diesel surcharge to encourage less polluting vehicle choices. Cease provision of Euro 5 exemption in 2017 once Euro 6 diesels are available.	EH/Tr	Diesel surcharge increased and exemption removed	Dec-17	The surcharge was raised to £40 in 2016 and the exemption for Euro 5 vehicles was removed in April 2017.



No	Action type	Action	Description	Body responsible	Target/measure	Deadline	Closing comments / progress
38	B	<b>Review of effectiveness of parking permit fee structure in encouraging the uptake of cleaner vehicles</b>	Review Parking Policy banding to encourage choice of lower-emission vehicles.	Tr	Parking policy reviewed	June-16	This work was postponed due to staff shortage and has now been restarted with a view of implementing changes in April 2019.
39	HPCL	<b>Increase number of on- street charging points for electric vehicles</b>	Expand the availability of on- street charging points for electric vehicles.	Tr	12 charging points	Apr-16	In late 2017 we began installing an additional 50 lamp column charging points across the borough. For 2018-19 we are looking into introducing some 22kW and 50kW rapid electric vehicle charging points.
40	HPCL	<b>Encourage car clubs to go electric</b>	Explore with car club operators the potential for introducing or increasing the number of electric cars or hybrid electric vehicles in their fleets.	Tr	Car clubs and other local authorities approached	Mar-17	We have reviewed our car club parking permit prices to improve the business case for operators to fund their own charging points at car club bays.
41	HB	<b>Encourage children to walk or cycle to school</b>	Double the number of schools with Silver or Gold accredited School Travel Plans and promote walking and cycling to school as part of a combined effort to tackle childhood obesity. Introduce advice on engine idling in promoting and creating travel plans	Tr	Number of schools with Silver or Gold accredited Plans doubled	Dec-17	In 2016-17, 38 schools have accredited travel plans, 15 at gold level, 6 at silver and 17 at bronze level. A further 2 schools started a new travel plan that will be accredited next year. The drop in school travel plans is reflective of a drop London-wide overall. 2017-18 figures will be available from July 2018 (end of school year).

No	Action type	Action	Description	Body responsible	Target/measure	Deadline	Closing comments / progress
42	H B	<b>Use cycle training to promote more cycling</b>	Encourage greater use of cycling, by increasing the number of free cycle training sessions for residents, visitors and workers in the borough.	Tr	1,000 people trained	Dec-16	<p>1,091 sessions of cycle training took place with adults and 1,600 sessions took place with children in 2017-18.</p> <p>870 sessions of cycle training took place with adults in 2016-17, a further 1,057 sessions took place with children.</p>
43	B P C	<b>Help the Mayor of London to create Cycling Grid of specially designed routes</b>	Work with the Mayor of London to improve cycle routes in London by introducing the Cycling Grid.	Tr/	Cycling grid implemented	Dec-16	<p>All Phase 1 routes and wayfinding were completed in 2017/18 and a new set of 'Phase 2' routes were developed in late spring. Feasibility studies have been undertaken and these are now with TfL for sponsor review.</p> <p>By the end of March 2017, all but one route of the cycling Grid had been completed, and this was on track to complete by the end of April 2017, with wayfinding to be done by summer 2017.</p>
44	B P C	<b>Open up more one-way streets to cyclists using both directions</b>	Continue to convert one-way streets to two-way operation for cycling.	Tr	Increase in schemes	Ongoing	<p>We have designed a dozen new two-way cycling schemes and will consult on these in 2018.</p> <p>We introduced several new two-way cycling schemes as part of the Grid project (action 43) and also opened up a route in Phillimore Walk as a low-traffic alternative to Kensington High Street.</p>

## BUSINESS AND COMMUNITY

- **NO<sub>2</sub> emission contribution: 19% from gas boilers; 49% from road transport**
- **PM10 emission contribution: 75% from road transport**
- **CO<sub>2</sub> contribution: 60% from commercial buildings; 29% from residents' homes; 11% from road transport**
- **10.7% of residents living in fuel poverty**



N <sup>o</sup>	Action type	Action	Description	Body responsible	Target/measure	Deadline	Closing comments / progress
49	B R	<b>Support local businesses and large organisations to reduce emissions from their operations</b>	Offer environmental advice and sources of technical information to local businesses and large organisations on how to reduce their CO <sub>2</sub> and air pollution emissions.	CC/Ec/EH/PH	Information available online. Number of businesses engaged	Dec-17	<p>The RBKC carbon dioxide emissions data (CO<sub>2</sub>) published by BEIS in June 2017 for the period between 2005-2015 was analysed. A report was produced to highlight the results and to show the carbon emissions produced by the industry sector. Projects are being assessed.</p> <p>Piloted a project with businesses in the King's Road in 2016, by engaging with 129 retail businesses to encourage them to close their doors when the heating / air-conditioning is on or when there are high levels of air pollution. The action of closing the door both prevents energy being wasted and reduces carbon consumption. The pilot project resulted in 23 businesses pledging to close their doors. Results from the pilot found showed an increase of 9% in retailers closing their doors following the engagement period. If these retailers continued to close their doors for one year, potentially 240 tonnes of carbon dioxide emissions would be saved.</p> <p>Reviewing the Carbon Trust Green Business Fund in 2017 and planning to engage with SMEs in</p>

No	Action type	Action	Description	Body responsible	Target/measure	Deadline	Closing comments / progress
							2017 to help them apply and identify opportunities to reduce their energy costs.
50	H B	<b>Work actively with some large business organisations to help them reduce their emissions</b>	Increase the number of businesses participating in emissions reduction initiatives by concentrating on large organisations in line with the Healthy Workplace Charter, starting with those already approached but not previously ready to commit.	EH	Six more participating organisations committed	Dec-17	<p>We are working with the Clean Air Better Business (CABB) project funded by the Mayor’s Air Quality Fund (MAQF) which is implemented by the Cross River Partnership (CRP) who actively approach and engage with businesses within the borough to improve air quality by:</p> <ul style="list-style-type: none"> <li>• Making deliveries to businesses more efficient, reducing congestion and air pollution while saving time and money via the deliverBEST online tool and business support service;</li> <li>Addressing the air quality impact of online shopping and personal deliveries via the ‘Click. Collect. Clean Air’ behaviour change campaign;</li> <li>• Communicating air quality messages with the business community.</li> <li>• Delivery and Servicing Plans for businesses to rationalize movements, reduce traffic and congestion and achieve time, cost and emissions savings;</li> <li>• Travel to work plans – to make travel to work more sustainable;</li> <li>• A directory of suppliers using zero and low emission (ZLE) vehicles – to enable businesses to choose to use ZLE vehicles providers/services;</li> <li>• Promotion of zero and low emission vehicles to businesses, the public sector and the taxi and private hire industries.</li> </ul> <p>CABB are promoting deliver BEST directly to businesses in some initial areas including High Street Kensington, Notting Hill and Holland Park</p>

No	Action type	Action	Description	Body responsible	Target/measure	Deadline	Closing comments / progress
							<p>Avenue.</p> <p>It was announced this year that Westminster City Council ((Cross River Partnership) with Lambeth, Islington, Kensington &amp; Chelsea, Hammersmith &amp; Fulham, Lewisham) were successful in their application to the Defra Clean Air Fund for funding to work with businesses across 5 boroughs to help reduce their emissions £232,850.</p> <p>In RBKC the funding will be used to focus on two areas in the borough Earl's Court Rd / Warwick Rd – GLA AQ Focus Area 116 (RB Kensington &amp; Chelsea) and Ladbroke Grove/Westway – Borough AQ Focus Area (Kensington &amp; Chelsea).</p>
53	P C L	<b>Continue to work with our main contractors to reduce their energy consumption</b>	Work in detail with the Council's main contractors (Suez, Quadron, Amey) to reduce their overall energy consumption related to the Council's operations (building use and vehicle fleets).	CC/CpS/W	280 tonnes CO <sub>2</sub> reduction versus 2013-14	Mar-17	<p>There is ongoing work with the Council's main contractors (Suez, Quadron, GLL and Amey) to reduce their energy consumption, fleet usage and operations.</p> <p>The contractors are included in the scope of the 40% carbon reduction target and their performance is monitored quarterly by the Climate Change Programme Board.</p> <p>In 2017/18 all our contractors decreased their carbon emissions when compared to 2007/08 (baseline year).</p> <ul style="list-style-type: none"> <li>• Suez (Council's Waste Contractor): 33.3% carbon emissions reduction since 2007/08</li> <li>• GLL (Council's Leisure Centres Contractor): 6.6% carbon reduction since 2007/08</li> <li>• Other Contractors: 54.8% reduction since 2007/08</li> </ul> <p>New carbon reduction targets have been set up for</p>

No	Action type	Action	Description	Body responsible	Target/measure	Deadline	Closing comments / progress
							2019/20 for the Council's internal stakeholders and contractors.
55	BPCR	<b>Pilot the commercial production of fresh products from market gardens in the borough</b>	Set up Cultivating Kensington and Chelsea to develop market gardens, allowing the commercial production of fruit, vegetables, plant seedlings and cut flowers.	RBEP	One new community-led food growing social enterprise Completed.	Dec-15	<p>The food growing charity (social enterprise) called Cultivating Kensington and Chelsea was completed in 2016 and has been running since then. Income from plant sales is made available in the form of grants to garden clubs in the borough. Each garden club can apply for up to £300 each year. This funding helps support established garden clubs and allows new clubs to become better equipped. 13 garden clubs benefitted from the scheme this year.</p> <p>Weekly sales were held of fruit, vegetable and herbs seedling at Portobello Road and Olympia station during the growing season.</p> <p>Ten new community gardens have been installed across the Borough, including at Notting Barns House, Convent Gardens Estate and St Charles Square. More gardens are planned for 2017/18.</p>
57	B P C	<b>Conduct an awareness-raising campaign for residents to increase waste recycling rates and decrease contamination</b>	Conduct awareness-raising campaign for residents on waste recycling and how to decrease contamination.	WAW	24.09% household recycling rate; 15.57% contamination rate	Mar-16	A communication and work plan was delivered to encourage residents to recycle more and produce less waste. This included: livery panels on waste collection vehicles, leaflets to all household explain what can be recycled and how, website updates, new street based recycling centres, the introduction of new food waste collection in Chelsea and a borough wide garden waste service.

## GREENING MEASURES AND LOCAL IMPROVEMENTS

- Reduce costs to NHS.
- Reduce impacts of both NO<sub>2</sub> and PM<sub>10</sub> emissions.
- Reduce impacts of severe weather conditions (e.g. floods, heatwaves).



N <sup>o</sup>	Action type	Action	Description	Body responsible	Target/measure	Deadline	Closing comments / progress
58	B R	<b>Produce a Local Flood Risk Management Strategy</b>	Produce a Local Flood Risk Management Strategy (LFRMS), required by the Flood Risk Regulations 2009 and the Flood and Water Management Act 2010.	PI	LFRMS action plan completed	Adoption of the strategy Sep-2015	The Local Flood Risk Management Strategy is now adopted. Actions that come from this include looking at flood prevention measures in Critical Drainage Areas and these are currently being investigated. Several reports on flood risk and SuDS feasibility have been commissioned and finalised to implement the actions regarding Critical Drainage Areas. We are currently looking for funding to implement SuDS in these areas.
61	R L	<b>Retrofit SuDs in existing properties</b>	Install SuDs such as rainwater retention features in existing properties.	PI	Arundel Gardens permeable paving scheme in place	Mar-17	Arundel Gardens was finalised in March 2017. Thames Water and Imperial College London are undertaking monitoring to ensure that the pilot project remain robust in terms of measurable outcomes so to influence future schemes.  Regarding the new draft policy CE2(i), as per 2016. The Local Plan Partial Review (LPPR) is currently at examination with hearings held in February and March 2018. Once the Inspector's report is received (expected in summer 2018), the Council will be in a position to adopt this policy.

RBKC Air Quality and Climate Change Action Plan 2016–2021 – Actions Completed 2016-2018

N <sup>o</sup>	Action type	Action	Description	Body responsible	Target/measure	Deadline	Closing comments / progress
64	HPCRL	<b>Install at least one green roof</b>	Install, as a pilot project, at least one green roof or comparable green infrastructure, in locations to be confirmed.	CC	One green roof installed	Oct-16	Action completed. Two green roofs were installed at Al Manaar Muslim Cultural Heritage Centre and on an Octavia social housing estate on Portland Road in 2017.
68	HBPCL	<b>Investigate whether targeted greening of areas can reduce exposure to poor air quality</b>	Assess the benefits of greening measures on school premises and other institutions close to busy roads, using the evaluation report on the green screen at St Cuthbert with St Matthias school and its capacity to reduce NO <sub>2</sub> and fine particle levels.	EH	Assessment completed. At least five target areas identified	Mar-16	<p>This action has been completed and previously reported upon. The study (see 'Further Information') and the Council's experience of utilising green infrastructure has been used to inform the Mayor's School Air Quality Audits, undertaken in 3 schools in the borough.</p> <p>The screen was found to be an effective pollution barrier once the ivy had started growing and a significant impact could be seen once the screen had matured. The ivy screen led to a decrease in the pollution concentrations on the playground side of the screen by 24% for NO<sub>2</sub> and 38% for PM<sub>10</sub>; both were higher than the measurement uncertainty and thus significant. Comparing school hours independently a reduction in concentrations of up to 36% and 41% were found for NO<sub>2</sub> and PM<sub>10</sub>, respectively.</p> <p>This demonstrates that the screen is very effective during daytime hours, when both emissions and exposure are highest.</p>
69	HBPCL	<b>Build and publicise green screens between Westway roads and sports area</b>	In cooperation with the Westway Trust and TfL, install green screens adjacent to the games area and next to one of the Westway slip roads, and raise awareness of	EH	Green screen installed	Jul-15	54 m (2.8 m high) length of ivy based green screening installed and completed by April 2016. See action 36, The Council continue to work with Westway Trust to improve air quality, such as the Vehicle Idling Action Day that was completed early 2018.



N <sup>o</sup>	Action type	Action	Description	Body responsible	Target/measure	Deadline	Closing comments / progress
			air quality in the local environment.				<p>As per action 50 It was announced this year that Westminster City Council (Cross River Partnership) with Lambeth, Islington, Kensington &amp; Chelsea, Hammersmith &amp; Fulham, Lewisham) were successful in their application to the Defra Clean Air Fund for funding to work with businesses across 5 boroughs to help reduce their emissions £232,850. In RBKC the funding will be used to focus on two areas in the borough.</p> <p>One of which will be Ladbrooke Grove/Westway – Borough AQ Focus Area (Kensington &amp; Chelsea). A number of independent traders and community groups occupy the space under the Westway. The Westway Trust coordinate business in the area. A range of independent traders and market stall holders and there is an active night time economy with a number of restaurants.</p>
70	HBPC	<b>Use greening measures to reduce pedestrians' exposure to poor air quality on Cromwell Road</b>	Develop the air quality aspect of the Cromwell Road green corridor project. Proposal set to re- landscape part of Cromwell Road's southern sidewalk.	EH/W	Greening measures installed	Mar-16	This project is now managed by TfL and is on hold as scheme being linked to other local transport schemes, but landscaping improvements along the southern section of West Cromwell Road have been completed.

## LOBBYING AND PARTNERSHIP

- National and regional policies and initiatives have significant impact at a local level.



N <sup>o</sup>	Action type	Action	Description	Body responsible	Target/measure	Deadline	Closing comments / progress
72	B L	<b>Join Climate Local, the commitment by local authorities to address climate change</b>	Join Climate Local to take advantage of the Local Government Association initiative providing additional support to reduce CO <sub>2</sub> emissions and improve resilience to the effects of climate change.	CC	Member of Climate Local	Ongoing	<p>RBKC signed in March 2015 the Local Government Associations (LGA) Climate Change commitment – called Climate Local, which aimed to support Councils’ efforts both to reduce carbon emissions and to increase resilience to a changing climate.</p> <p>The action is now completed as Climate Local does not exist anymore. Resources and partnership working with other London borough were facilitated through this platform/network.</p>
74	HBPC	<b>Push for the borough to be included in the Ultra Low Emission Zone (ULEZ)</b>	As part of the TfL/GLA Engagement Group, enter discussions with the new Mayor of London on the potential to increase the air quality benefits in the borough of the ULEZ proposal, and/or tightening the LEZ.	EH/Tr	Information obtained and assessed	Mar-17	The Leadership Team fully supported the latest (and final) of the Mayor’s consultations to extend the ULEZ to the N/S Circulars in February 2018. If the proposals are accepted, the extension to include RBKC will come into force for HGVs in October 2020 and for light vehicles in October 2021.

75	H P C	<b>Support TfL in ensuring that the entire borough is part of the Cycle Hire scheme</b>	Support the expansion of the Cycle Hire scheme north of the Westway.	Tr	Whole of the borough served by the scheme	Dec-18	TfL is not planning to extend Cycle Hire any further at this time, however the recent arrival of dockless bicycle operators has potential to help fill this gap.
76	P C	<b>Work with TfL to reduce emissions from buses in the borough</b>	Lobby and work with TfL to ensure that all bus routes through the borough are ULEZ-compliant and explore options for hybrid buses to run in pure electric mode through the most polluted areas.	EH/Tr	Reduction of 20 tonnes of NOx	Dec-17	<p>We have worked with TfL to improve bus journey times along Kensington High Street as part of the LEBZ initiative. Changes are due to be made to the signal timings at the junction of Kensington Church Street and Kensington High Street which will reduce the time buses spend queuing at these lights.</p> <p>The Mayor of London has announced that the Kensington High Street corridor will be a Low Emission Bus Zone. We have engaged with TfL to seek information on the composition of the bus fleet, most of which will have to meet Euro 6 standards by 2019 because of the ULEZ.</p>
77	B	<b>Work with TfL to deliver a Crossrail station in the borough</b>	Work with TfL on delivery of Crossrail 2 station in the King's Road area.	EH/Tr/PI	Confirmation of station location 2018		No progress. TfL's consultation on Crossrail 2 is on hold pending outcome of the Independent Affordability Review.
78	B	<b>Lobby TfL for increased public transport links in the borough</b>	Continue to work with Crossrail sponsors on feasibility of a Kensal Portobello Crossrail station at Canal Way.	EH/Tr/PI	Confirmation in principle of a station, or new link	Dec-18	GRIP 1 study completed, and focus is now on railway timetable modelling work.
79	B	<b>Lobby TfL and the Mayor of London to reduce emissions from taxis</b>	Lobby TfL/Mayor of London to make the decommissioning scheme for 10 year old taxis mandatory.	EH	100% of 10 year old taxis de-commissioned	Dec-18	The council collaborated with London Councils on their consultation response to the Mayor of London's Environment Strategy and expressed that the plans do not go far enough to cut emissions from taxis and private hire vehicles. It specified that a requirement for zero emission

RBKC Air Quality and Climate Change Action Plan 2016–2021 – Actions Completed 2016-2018

							capable taxis by 2033 is too late.
--	--	--	--	--	--	--	------------------------------------

